

WESTFIELD[®]

GRAIN AUGERS

PTO-SD

**ASSEMBLY &
OPERATIONS
MANUAL**

**Model 'WR'
SD-04-04**

Table of Contents

1. Introduction	1
2. Safety First	3
3. Assembly	8
4. Transport & Placement	26
5. Operations	29
6. Maintenance & Storage	33
7. Index	35
Sign-Off Form	Inside Front Cover
Warranty	Inside Back Cover

1. Introduction

Congratulations. As the new owner of a WESTFIELD PTO-SD Grain Auger, you will be working with equipment especially designed to complement and improve your farming operation. Before using this auger, we recommend that you read this manual and familiarize yourself with the various features of the machine and the necessary precautions for an efficient and safe operation.

In addition, we suggest that anyone using this auger be required as a matter of record to be familiar with all safety precautions. A sign-off form is supplied on the inside cover for your convenience and permanent records.

Thank you.





Watch for this symbol. It identifies potential hazards to health or personal safety. It points out safety precautions. It means: ATTENTION - Be alert. Your safety is involved.

Failure to read this auger manual before operating the auger is a misuse of the equipment and a needless risk of life and limb.



2. Safety First

Safety first! Everyone knows about it. Most people practise it. Sadly, a few choose to ignore it. Safety should be a habit, something you practise every time you work with machinery. Safe working habits prevent needless accidents and needless injuries or deaths.

Whether you are the owner, a supervisor, or an operator, it is **your** responsibility to know the operational requirements, the safety precautions and the potential

hazards of portable grain augers. Furthermore, you must ensure that anyone working with or around the augers be familiar with them. Failure to read this manual and/or noncompliance with correct safety procedures is a misuse of equipment. Remember, a lack of knowledge serves only to endanger yourself and those around you.

TAKE THE TIME - BE ALERT - BE SAFE

2-1. OPERATIONAL SAFETY

Operational safety means using common sense. Moreover, it means knowing and observing proper precautions. Always remember to:

Keep children and untrained people away from auger work area (see **Figure No. 1**). The area around an auger is not safe for untrained personnel, and especially not safe for children.

Have another person nearby who can shut down the auger in case of accident. It is good practise to always work with a second person around augers.

Inspect the lift cable before using auger. Replace if frayed or damaged.

Ensure that auger is empty before raising or lowering.

Ensure that winch is locked before operating auger.

Augers are not insulated. Keep away from electrical lines. Electrocutation can occur without direct contact.

Do not operate any auger with any safety shield removed, including tractor shields.

Never use a PTO driveline without a rotating shield in good working order.

Be certain the PTO driveline is securely attached to the gearbox and to the tractor.

Before starting tractor, be certain that power to PTO is in the off position.

Keep body, hair, and clothing away from moving parts.

Operate the auger on level ground free of debris. If ground is uneven, anchor the auger to prevent tipping or upending.

Support the discharge end and/or anchor the intake end before operating to prevent upending.

Shut off all power to auger before servicing, cleaning, or adjusting.

Keep away from auger intake during operation.

Lower auger at completion of operation, or when not in use.

Make certain lift cable is properly seated in cable pulleys.

Wear hearing protection when operating auger.

2-2. TRANSPORT AND PLACEMENT SAFETY

The approach to transport and placement safety is no different than that of operational safety. Follow the basic rules of good sense and know the limitations of your machinery. While a few of the precautions are the same, they bear repeating. Remember to:

Keep children and unauthorized personnel away from the hazard area surrounding auger.

Transport auger in full down position with slight tension on cable.

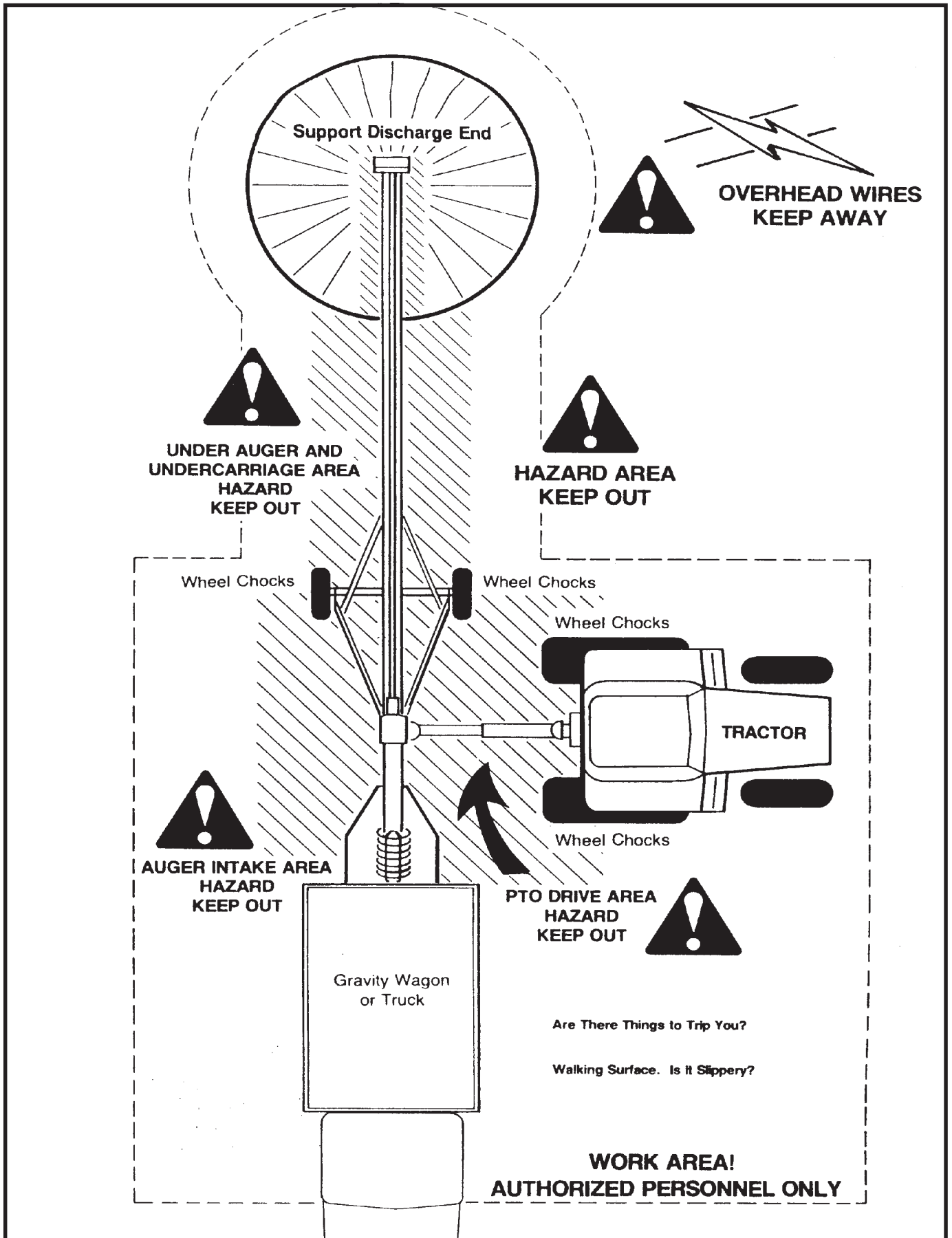

Figure No. 1

Check the lift cable before each use and replace if frayed or damaged.

Make certain that the hitch pin is in place and the safety chain is properly attached. Use a type of hitch pin that will not permit auger to separate from towing vehicle.

Always attach a SMV (Slow Moving Vehicle) sign before transporting auger.

Before moving auger, make sure the area around the auger is clear of obstructions and/or unauthorized personnel (see **Figure No. 2**).

Before moving auger, check and double check for overhead obstructions and/or electrical wires. Electrocutation can occur without direct contact.

Disconnect PTO driveline from tractor before moving auger or tractor.

Secure the PTO driveline in transport saddle before moving auger.

Equip the auger with necessary lights for transportation where required by law.

Do not transport auger faster than 15 mph (24 km/h).

Do not transport auger on a slope greater than 20 degrees.

Use extreme caution in turning and cornering.

Do not raise or lower auger until the hazard area is clear.

Do not permit anyone to stand on or beneath auger when raising or lowering.

When lowering auger, never continue to turn winch handle counter-clockwise if the cable does not keep moving out under load. This will disengage the brake mechanism and will create an unsafe condition. This condition generally indicates that the track shoe is stuck. Too much slack in the cable could allow auger to drop suddenly. To correct the problem, winch in the slack cable and correct the sticking track shoe.

The winch must have a clicking sound when raising auger. If clicking sound stops, retain grip on handle, lower auger fully and repair winch.

After lowering auger, turn handle clockwise two clicks to lock winch brake.

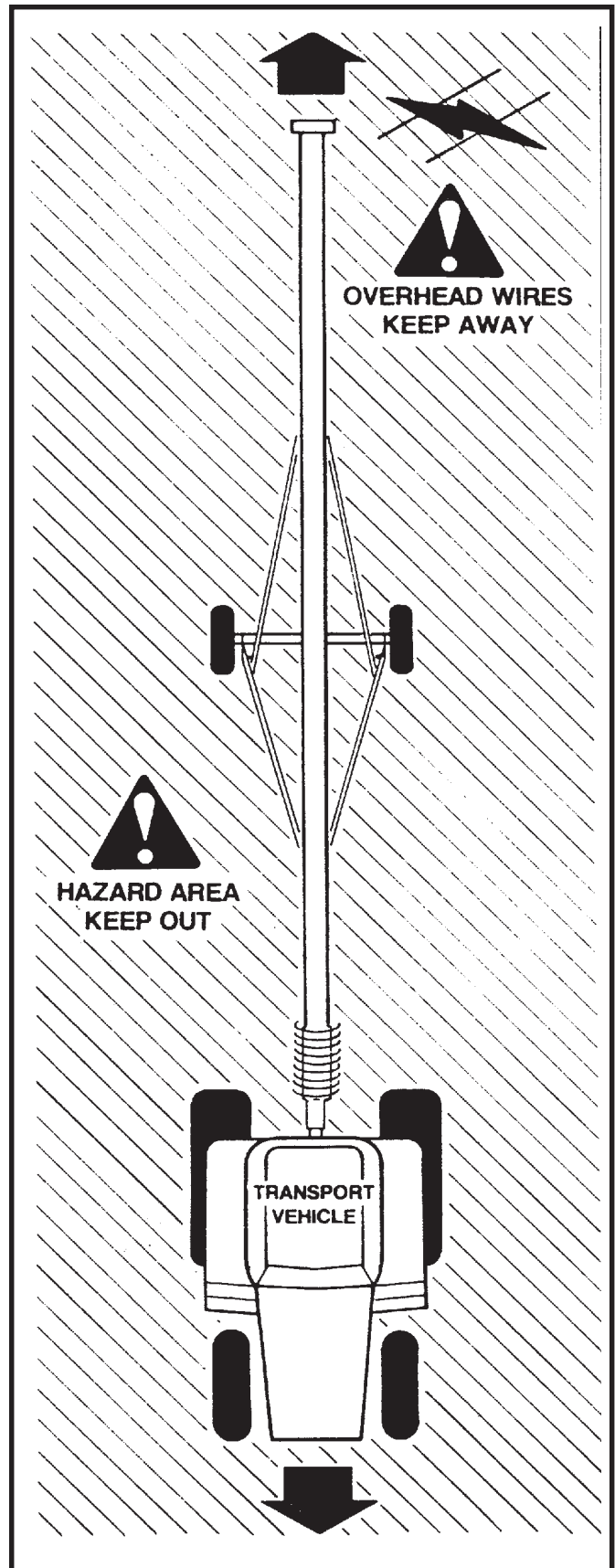

Figure No. 2

Always keep a minimum of three cable wraps on the winch drum.

The winch is designed for MANUAL operation only.

Wheels must be free to move when raising or lowering auger. DO NOT USE AUGER AS A HOIST.

2-3. MAINTENANCE SAFETY

When performing maintenance on the PTO-SD auger, understand and observe the following precautions.

Support auger tube before attempting maintenance of any kind. Auger should be in full down position for maintenance.

Shut down and lockout all power before attempting maintenance of any kind. If lockout is impossible, disconnect auger drive from tractor.

Keep decals clean. Replace any decal that is damaged or not clearly visible. Available upon request.

After maintenance is completed, replace and secure all safety shields and safety devices.

Use only genuine WESTFIELD replacement parts or equivalent. Replacement parts such as intake shields, pulley shields, PTO driveline shields, winches and lift cables MUST MEET ASAE STANDARDS or serious injury may result. Use of unauthorized parts will void warranty. If in doubt, contact WESTFIELD or your WESTFIELD dealer. Do not modify any auger components.

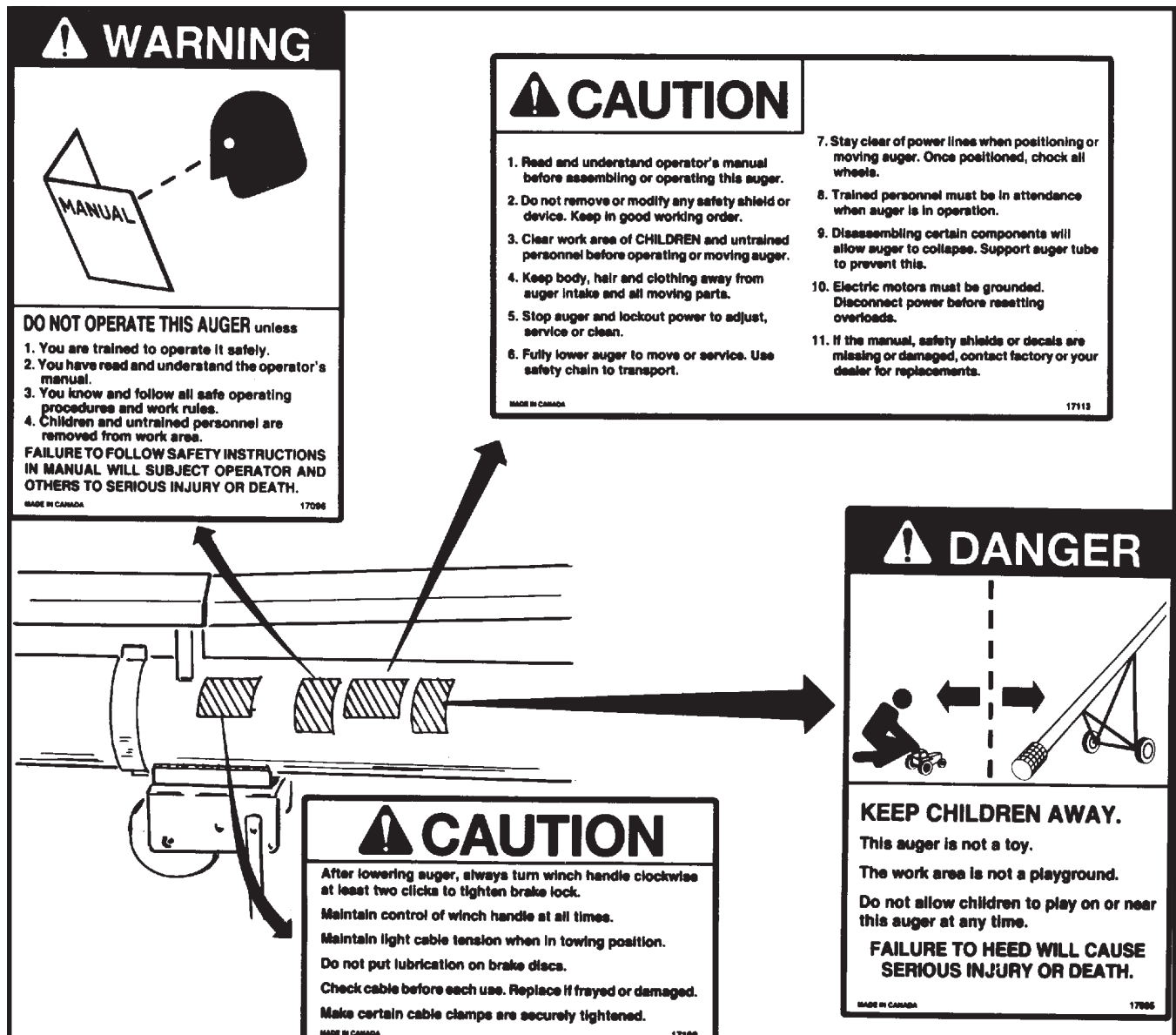
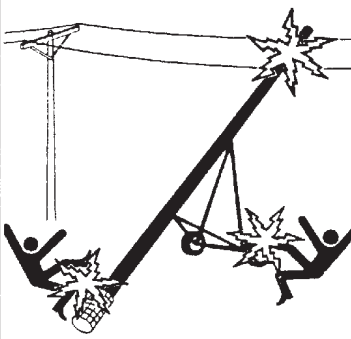

Figure No. 3

⚠ DANGER



ELECTROCUTION HAZARD
 This auger is not insulated.
 Keep auger away from overhead power lines and devices.
 Electrocution can occur without direct contact.
 Fully lower auger before moving.
FAILURE TO KEEP AWAY WILL RESULT IN SERIOUS INJURY OR DEATH.

MADE IN CANADA 17102

⚠ DANGER



ROTATING PTO DRIVELINE HAZARD
 Keep your body, hair, clothing and others away from rotating PTO driveline.
 Do not operate auger unless all driveline, tractor and equipment shields are in place and in good working order.
 Make certain the driveline shields turn freely on driveline.
 Make certain the driveline is securely attached at both ends.
 Do not exceed operating speed of 540 RPM.
 Keep u-joints angles small and equal. Do not exceed maximum recommended length.
FAILURE TO HEED WILL RESULT IN SERIOUS INJURY OR DEATH.

MADE IN CANADA 17103

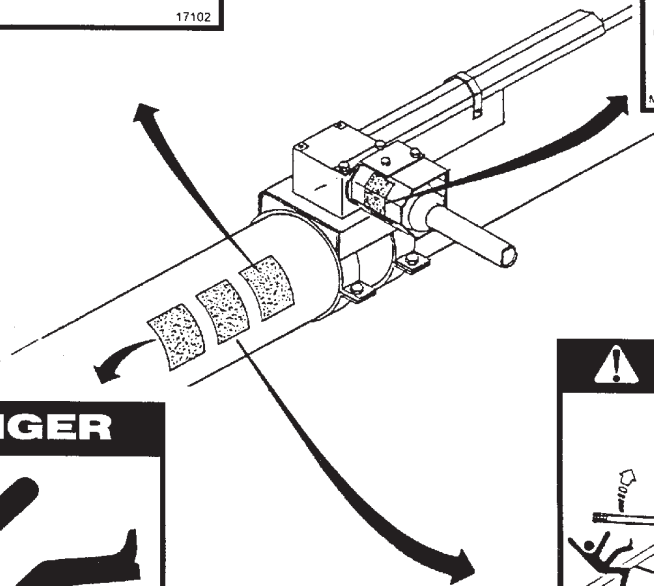

⚠ DANGER



ROTATING FLIGHTING HAZARD
 Keep away from auger intake.
 Keep intake shield in place and in good working order. Do not modify.
FAILURE TO HEED WILL RESULT IN SERIOUS INJURY OR DEATH.

MADE IN CANADA 17098

⚠ DANGER

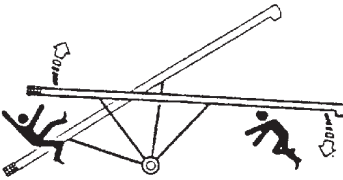

UPENDING HAZARD
 Anchor intake end and/or support discharge end to prevent upending.
 Auger intake must always have downward weight. Do not release until attached to tow bar or resting on ground.
 Do not raise auger intake above tow bar height.
 Use a tow vehicle to move auger.
 Empty auger and lower fully before moving.
FAILURE TO HEED WILL RESULT IN SERIOUS INJURY OR DEATH.

MADE IN CANADA 17097

Figure No. 4

3. Assembly

(Contact Westfield Industries Ltd. for details)

4. Transport & Placement

When transporting the PTO-SD auger, we strongly recommend that all safety precautions be observed, that a proper towing vehicle be used, and that transport procedures as detailed below be followed.

CAUTION

KEEP CHILDREN AND ALL UN-AUTHORIZED PERSONNEL AWAY.

ATTACH A SMV SIGN BEFORE TRANSPORTING AUGER.



DO NOT TOW FASTER THAN 15 MPH (24 km/h).

USE EXTREME CAUTION IN TURNING AND CORNERING.

DO NOT TOW AUGER ON SLOPES GREATER THAN 20 DEGREES.

DO NOT ALLOW PERSONS TO STAND BENEATH OR RIDE ON THE AUGER WHEN IT IS BEING TRANSPORTED. (See Figure No. 2.)

4-1. PRE-TRANSPORT CHECKLIST

Before Transporting auger, ensure that:

1. Auger is in full down position. The roller track shoe should be seated against the upper track stop with slight tension on the lift cable.

IMPORTANT

WINCH MUST BE IN LOCKED POSITION. TO LOCK, TURN HANDLE CLOCKWISE UNTIL TWO CLICKS ARE HEARD. CHECK CABLE BEFORE EACH USE. REPLACE IF DAMAGED OR FRAYED.

2. **Make certain** that the hitch pin and safety chain are in place and secure. The safety chain should be threaded through handle on the lower tube and wrapped around auger tube before attaching to the towing vehicle.

NOTE: We recommend that a type of hitch pin be used that will not allow auger to separate from towing vehicle. (See **Figure No. 29**)

3. Ensure that PTO driveline is in transport saddle and secure.

NOTE: If auger wheels are partially or fully buried in snow or grain, do not attempt to move auger until snow or grain has been cleared away from auger wheels. Failure to heed may cause damage to auger and/or serious injury.

4-2. TRANSPORT PROCEDURE

When transporting auger, remember to:

1. Ensure that all unauthorized personnel are clear of transport zone. (See **Figure No. 2**)
2. Be alert to overhead obstructions and electrical wires and devices. The PTO-SD augers have minimum clearances from 9'0" (2.74 m) to 15'6" (4.72 m), in normal transport position.

DANGER

ELECTROCUTION HAZARD



THIS MACHINE IS NOT INSULATED. KEEP AWAY FROM OVERHEAD WIRES AND DEVICES. ELECTROCUTION CAN OCCUR WITHOUT DIRECT CONTACT.

FAILURE TO MAINTAIN PROPER CLEARANCE WILL RESULT IN SERIOUS INJURY OR DEATH.

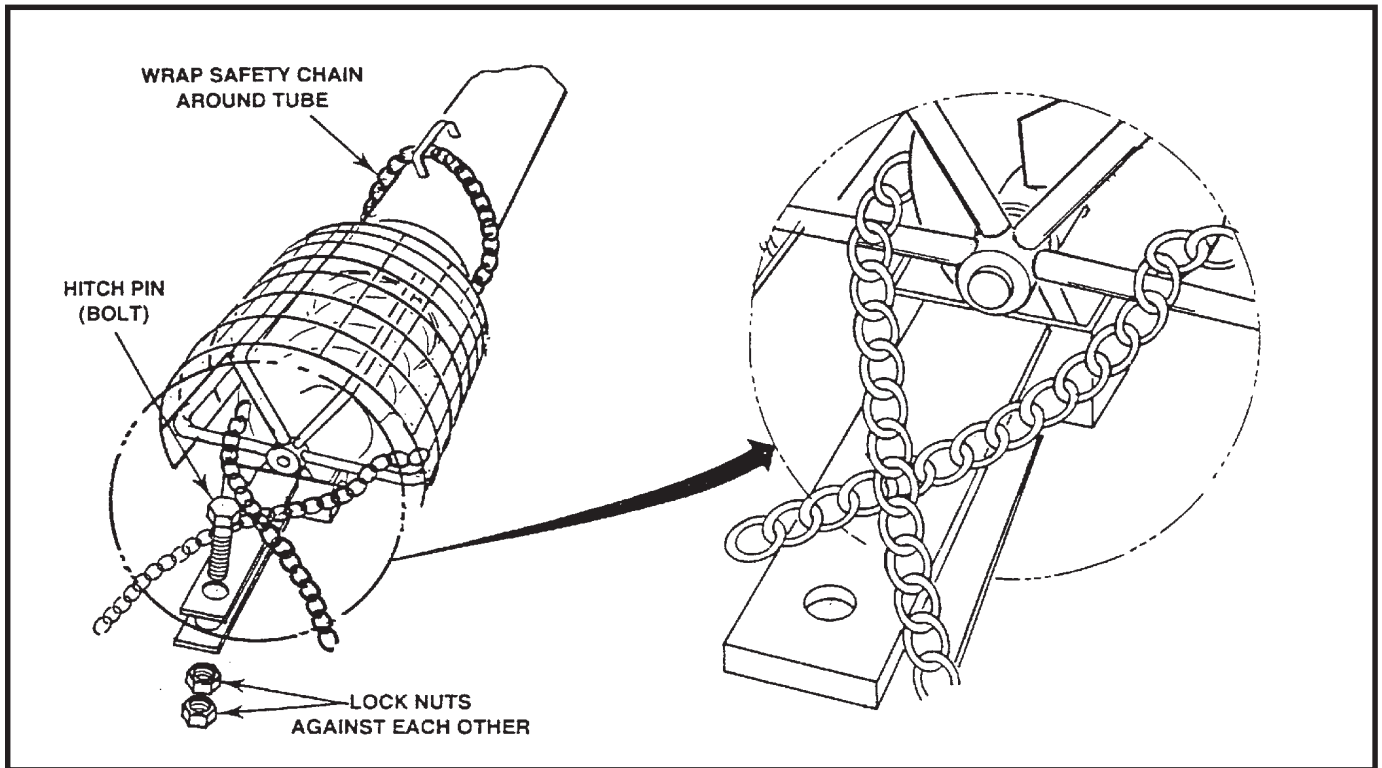

Figure No. 29

3. Observe all regulations concerning marking, towing, and maximum width.
4. Equip the auger with necessary lights where required by law.
5. Do not transport auger at speeds greater than 15 mph (24 km/h).
6. Do not transport auger on slopes greater than 20 degrees.
7. Use extreme caution in turning and cornering when towing auger.

4-3. PRE-PLACEMENT PROCEDURE

Before moving auger into position for operation, ensure that all safety precautions and placement procedures are observed.

IMPORTANT

BEFORE RAISING OR PLACEMENT OF AUGER, ENSURE THAT GROUND IS REASONABLY LEVEL. AUGER COULD TOPPLE IF GROUND IS TOO UNEVEN, DAMAGING EQUIPMENT AND/OR CAUSING PERSONAL INJURY.

CAUTION

KEEP CHILDREN AND ALL UN-AUTHORIZED PERSONNEL AWAY.

ENSURE AREA IS CLEAR BEFORE RAISING OR LOWERING AUGER.



DO NOT ATTEMPT TO MOVE AUGER BY HAND.

ALWAYS CHOCK WHEELS AFTER POSITIONING AUGER FOR OPERATION.

DO NOT USE AUGER AS A HOIST TO RAISE ANY OBJECT REGARDLESS OF WEIGHT. THIS WILL CREATE AN UNSAFE CONDITION AND WILL VOID WARRANTY.

Before positioning auger, the following steps are recommended:

1. Ensure that towing hitch is in place and secure.

NOTE: We recommend that a type of hitch pin be used that will not allow auger to separate from towing vehicle. (See **Figure No. 29**)

2. If the auger must be raised before positioning, make sure that the entire area in the line of travel, both on the ground and overhead, is clear of any obstructions or electrical wires.

DANGER



WATCH FOR OVERHEAD ELECTRICAL WIRES. ELECTRO-CUTION CAN OCCUR WITHOUT DIRECT CONTACT.

FAILURE TO HEED THIS WARNING WILL RESULT IN SERIOUS INJURY OR DEATH.

IMPORTANT

WHEELS MUST BE FREE TO MOVE WHEN RAISING OR LOWERING AUGER.

3. To raise auger, turn winch handle clockwise. Use a firm grip on winch handle, do not release unless the ratchet pawl is fully engaged.

IMPORTANT

DO NOT TURN WINCH HANDLE COUNTER-CLOCKWISE EXCEPT WHEN LOWERING AUGER, OR SEVERE DAMAGE TO WINCH WILL OCCUR.

NOTE: Winch must have clicking sound when raising auger. If clicking sound stops, retain grip on handle, lower auger fully, and repair ratchet. The winch is designed for **MANUAL** operation only.

4-4. PLACEMENT PROCEDURE

NOTE: If auger wheels are partially or fully buried in snow or grain, do not attempt to move auger until snow or grain has been cleared away from auger wheels. Failure to heed may cause damage to auger and/or serious injury.

NOTE: The PTO driveline is a non-separable type. Remove from tractor and secure in transport saddle on auger before moving tractor away from auger.

WARNING



NEVER ATTEMPT TO INCREASE HEIGHT OF AUGER BY POSITIONING WHEELS ON LUMBER, BLOCKS, OR BY ANY OTHER MEANS. TO DO SO WILL RESULT IN DAMAGE TO EQUIPMENT AND/OR PERSONAL INJURY.

1. Move auger into working position slowly, making sure that all persons are clear of the work area (see **Figure No. 1**). Do not unhitch auger and attempt to move by hand.
2. Once auger is in position, chock wheels on both sides. Also, chock wheels on the tractor, or apply the park brake.

IMPORTANT

WHEN RELEASING AUGER FROM THE TOWING VEHICLE, TEST THE INTAKE END FOR DOWNWARD WEIGHT. DO NOT RAISE THE INTAKE END ABOVE DRAWBAR HEIGHT. WHEN THE INTAKE END IS ELEVATED TOO HIGH WITH AUGER IN RAISED POSITION, THE BALANCE OF WEIGHT QUICKLY TRANSFERS TO THE DISCHARGE END, CAUSING THE AUGER TO UPEND.

3. When operating auger in the raised position, rest the discharge end on bin roof, or tie down to bin to prevent upending or wind upsetting auger. When operating auger in a freestanding position, anchor the intake end.

IMPORTANT

ANCHORING AND/OR SUPPORT OF AUGER DURING OPERATIONS IS NECESSARY. WHEN LOWER HALF OF AUGER EMPTIES OF GRAIN, THE WEIGHT BALANCE TRANSFERS TO UPPER END OF AUGER, WHICH CAN CAUSE UPENDING.

4. See Operations **Section 5-6** for correct lowering procedure.

5. Operation

Efficient operation of the PTO-SD auger requires that operators follow a checklist before each start-up and demands that safety precautions be observed at all times. To do otherwise is endangering life and limb, and is a misuse of equipment.

CAUTION

KEEP CHILDREN AND ALL UN-AUTHORIZED PERSONNEL CLEAR OF WORK AREA.

DO NOT OPERATE AUGER WITH ANY SAFETY SHIELD REMOVED.

ALWAYS HAVE ANOTHER PERSON NEARBY TO SHUT DOWN AUGER IN CASE OF ACCIDENT.



KEEP BODY, HAIR, AND CLOTHING AWAY FROM ANY MOVING PARTS.

WEAR HEARING PROTECTION DURING OPERATION.

SHUT DOWN AND LOCK OUT ALL POWER BEFORE SERVICING, CLEANING, OR ADJUSTING.

DO NOT USE AUGER AS A HOIST TO RAISE ANY OBJECT REGARDLESS OF WEIGHT. THIS WILL CREATE AN UNSAFE CONDITION AND WILL VOID WARRANTY.

5-1. PRE-OPERATION CHECKLIST

Before operating auger for the initial time, and each time thereafter, the operator must follow a prescribed checklist. The checklist should confirm the following:

All fasteners are secured as per assembly instructions.

All safety shields are in place and secure.

Oil level in gearbox is adequate, half full only. **DO NOT OVERFILL.** Overfilling will cause gearbox to fail.

IMPORTANT

ADD EP90 LUBE OIL TO THE GEARBOX BEFORE OPERATING AUGER. FAILURE TO DO SO WILL VOID WARRANTY.

PTO driveline is connected and secure.

PTO driveline shields rotate freely.

Lift cable is not frayed or damaged.

Cable clamps are secure.

Tube alignment is reasonably straight.

Auger and tractor wheels are chocked.

Discharge spout and intake area are free of obstructions.

Proper maintenance has been performed.

Operators are aware of all safety precautions.

5-2. AUGER DRIVE AND LOCKOUT

Correct operation of the PTO-SD auger requires pre-inspection of the drive system, operator knowledge on how to shut down the system, and a general monitoring of the system during operation.

PTO Driveline

1. Ensure that the PTO driveline is securely attached to the tractor and gearbox.
2. Do not use PTO driveline without a rotating shield in good working order.
3. Do not exceed the maximum operating length of 80 inches (2032 mm) of the PTO driveline or the maximum angularity of 15 degrees.

4. Be sure that the PTO drive on the tractor is in the off position before starting tractor.
5. Stay clear of PTO hazard area. (see **Figure No. 1**)

Lockout and/or Shutdown

1. Shut off engine.
2. Remove ignition key from tractor.
3. If step 2 is impossible, remove PTO driveline from tractor.

5-3. START-UP AND BREAK-IN

Start-up and break-in procedures for the PTO-SD auger are as follows:

1. Ensure that you have completed checklist at the beginning of **Section 5-1**.
2. If everything is satisfactory, prepare for a 30 minute operation at half speed, augering grain.
3. Ensure that portable grain hopper is correctly positioned and secured to auger with both straps (where applicable).

IMPORTANT

ANCHORING AND/OR SUPPORT OF AUGER DURING OPERATIONS IS NECESSARY. THEN LOWER HALF OF AUGER EMPTIES OF GRAIN, THE WEIGHT BALANCE TRANSFERS TO THE UPPER END OF AUGER, WHICH CAN CAUSE UPENDING

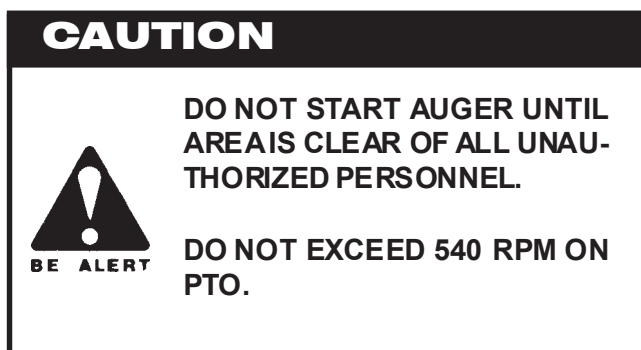

IMPORTANT

WHEN STARTING AUGER FOR THE FIRST TIME, BE PREPARED FOR AN EMERGENCY SHUTDOWN IN CASE OF EXCESSIVE VIBRATION OR NOISE. NOTE THAT AUGER MAY RUN ROUGH UNTIL TUBE IS POLISHED.

4. Start tractor and engage PTO. If auger functions normally, check at varying speeds for a period of 30 minutes.
5. Upon completion of initial run, slow down auger until empty, and stop.
6. Lock out tractor and conduct a complete inspection of auger, following the checklist in **Section 5-1**.
7. After the initial start-up and inspection, the auger should be shut down and inspected at least three times during the first 10 hours of operation.
8. Do not run empty auger at high speeds, as this results in excessive wear.
9. Once auger is broken in, the checklist should be a part of the daily routine before operating auger.

5-4. FULL LOAD PROCEDURES

For normal auger operations, the following procedures and safety precautions are strongly recommended.

1. When operating the auger, always work with a second person in a position to monitor the operation and initiate a shutdown in case of emergency.
2. Monitor the auger during the actual operation for abnormal noises or vibrations.
3. Observe the work area restrictions (see **Figure No. 1**). If unauthorized personnel enter the hazard zone, shut down the auger and clear the area before restarting.
4. Shut off all power before making adjustments, servicing, or clearing the machine.

5-5. NORMAL/EMERGENCY SHUTDOWN

The steps for a normal shutdown are as follows:

1. Near the end of a load, decrease auger speed until all grain is clear of machine.
2. When auger is clear, disengage the PTO.
3. Shut down and lock out tractor.

In the event of and intermittent or emergency shutdown, restart as follows:

1. If auger is full of grain, do not restart at full speed. Engage the PTO at low rpm, gradually increasing power, until normal operating speed is reached.

IMPORTANT

STARTING AUGER UNDER FULL LOAD MAY RESULT IN DAMAGE TO THE UNIT. BE SURE THERE IS NO BLOCKAGE.

2. If the auger is shut down for an emergency, lock out tractor before correcting problem. If the problem is clogging, clear as much of the grain as possible before restarting unit. (See **Section 5-2** for lockout procedures)

USE OF GRAIN SPREADERS: Most grain spreaders can not handle the large capacity of large diameter augers. As a result, the auger will plug causing damage to the flighting and other drive components. This type of damage is not covered by warrant.

Hints on how to avoid this...

- Get a larger spreader, if available
- Remove the spreader
- Suspend the spreader from bin ceiling leaving lots of room for excess grain to flow over the spreader
- Some farmers have suspended a curved disc about 14" - 16" from bin ceiling which is reported to do a good job of spreading the grain

BIN LEVEL INDICATORS: The WR augers are fast and bins fill up quickly. A full bin will cause auger to plug which will damage the flighting and other drive components.

Installing quality grain-level indicators on your bins will allow you to monitor the filling of the bin and help prevent damage to your auger.

5-6. COMPLETION/CLEAN-UP

At the completion of an operation, the auger should be moved to the next work area or to a storage area. The recommended procedure is:

1. Clean entire work area.
2. Remove all wheels chocks.
3. After ensuring that area is clear of all unauthorized personnel, move auger out of working position and lower fully.

IMPORTANT

THERE WILL BE NO CLICKING SOUND WHEN LOWERING AUGER. AFTER LOWERING AUGER, TURN HANDLE CLOCKWISE UNTIL YOU HEAR TWO CLICKS TO LOCK BRAKE. USE A FIRM GRIP ON WINCH HANDLE, DO NOT RELEASE UNLESS THE RATCHET PAWL IS FULLY ENGAGED. THE WINCH IS DESIGNED FOR MANUAL OPERATION ONLY.

CAUTION

DO NOT LEAVE AUGER IN RAISED POSITION WHEN NOT IN USE. AUGER COULD DROP RAPIDLY IN CASE OF CABLE BREAK. HIGH WINDS MAY ALSO UPSET AUGER.



WHEN LOWERING AUGER, NEVER CONTINUE TO TURN HANDLE COUNTERCLOCKWISE IF THE CABLE DOES NOT KEEP MOVING OUT UNDER LOAD. THIS WILL DISENGAGE THE BRAKE MECHANISM AND CREATE AN UNSAFE CONDITION. WHEN THIS OCCURS, WINCH IN SLACK CABLE AND CORRECT PROBLEM.

4. Prepare for transport and placement or storage. (See Transport & Placement **Section 4** for correct procedure. If storing, see Maintenance & Storage **Section 6** for storage procedures).

DANGER



BEFORE MOVING AUGER OUT OF POSITION, LOOK FOR ELECTRICAL WIRES AND OBSTRUCTIONS OVERHEAD.

ELECTROCUTION CAN OCCUR WITHOUT DIRECT CONTACT.

FAILURE TO HEED THIS WARNING WILL RESULT IN SERIOUS INJURY OR DEATH.

DANGER



NEVER USE A PTO DRIVELINE WITHOUT A ROTATING SHIELD IN GOOD WORKING ORDER.

DO NOT EXCEED MAXIMUM RECOMMENDED OPERATING LENGTH OR ANGULARITY OF PTO DRIVELINE.

6. Maintenance & Storage

Proper maintenance habits on the PTO-SD auger mean a longer life for the machine, and a more efficient and safe operation.

CAUTION

KEEP CHILDREN AWAY WHEN PERFORMING MAINTENANCE.

BEFORE PERFORMING ANY MAINTENANCE, ENSURE THAT POWER IS SHUT DOWN AND LOCKED OUT.



WHERE POSSIBLE, PERFORM MAINTENANCE WITH AUGER IN FULL DOWN POSITION.

REPLACE ALL SHIELDS.

6-1 GENERAL MAINTENANCE PROCEDURES

We recommend the following steps for the general maintenance of this auger.

1. Observe the checklist in **Section 5-1** on a daily basis when auger is in use.
2. Check all operating, lifting and transport components. Replace damaged or worn parts before using auger.

NOTE: To replace a damaged part, refer to Assembly instructions in **Section 3**.

3. **PTO Driveline:** Lubricate both universal joints after every 8 hours of operation. Lubricate the center portion of driveline (grease fitting is beneath shield) on a yearly basis.
4. **Upper Chain Drive:** Fill enclosed upper drive housing with grease.

WR60 and WR70	550 grams	20 oz
WR80 x 26' - 51'	750 grams	26 oz
WR80 x 56' - 71'	900 grams	32 oz
WR100	1100 grams	40 oz

For continuous use in extreme cold conditions, semi fluid arctic grease or heavy oil may be used.

5. **Intake Bushing:** Lubricate daily.
6. **Gearbox:** Maintain oil level at half full (center of cross shaft). Gearbox should be level when checking or refilling. DO NOT OVERFILL.

IMPORTANT

ADD EP90 LUBE OIL TO THE GEARBOX BEFORE OPERATING AUGER. FAILURE TO DO SO WILL VOID WARRANTY.

7. **Winch:**
 - (A) Maintain a light film of automotive type grease on the teeth of both the pinion and drum gears.
 - (B) Keep the ratchet pawl pivot, bushings and pinion threads lubricated with engine oil.

IMPORTANT

TAKE CARE NOT TO GET OIL OR GREASE ON BRAKE DISK.

(C) Replace brake disk if less than 1/16" thick, or if cracked or broken.

(D) Check for proper ratchet pawl operation as follows:

When cranking in cable (CLOCKWISE) a loud clicking sound should be heard.

When cranking out cable (COUNTER-CLOCKWISE) there is no clicking AND the ratchet pawl must be fully engaged into the gear teeth.

8. **Lift Cable:** Check and replace if frayed or damaged. Make certain that cable clamps are secure.
9. **Truss Cables:** On augers so equipped, adjust as needed to keep auger tube reasonably straight.
10. **Wheel Hubs:** Repack every two or three years with lithium based grease.
11. **Tire Pressure:** Check with a pressure gauge monthly or when tire pressure seems low. We recommend that pressure be maintained at 18-24 psi (124-165 kPa).

6-2. GENERAL STORAGE PROCEDURES

To protect auger in storage during the off season, we suggest the following:

1. Lower the auger to full down position with a slight tension on cable.
2. Lubricate all grease fittings per maintenance procedures.
3. Inspect auger for damage and note any repairs required. Order replacement parts from your dealer.
4. Check tire pressure and inflate to 24 psi (165 kPa).
5. Clean and lubricate the spline on PTO driveline. Cover with a plastic bag to protect it from the weather and lock it in the transport saddle.
6. Tow auger to storage area. Park and chock wheels.

To prepare auger for use after storage, we recommend the following:

1. Check tire pressure and inflate to 18-24 psi (124-165 kPa) if necessary.
2. Tow auger to worksite, being mindful of electrical wires overhead. (See **Transport & Placement Section 4** for correct procedures.)
3. Remove waterproofing from spline on PTO driveline and relubricate.

4. Check oil level in gearbox and refill if needed, half full only. **DO NOT OVERFILL.**
5. On augers equipped with lubricated upper drive, check level of lubrication annually and add as needed. Refill to plug level.
6. Replace any damaged parts.
7. Conduct general maintenance procedures before using auger.

Use only genuine WESTFIELD replacement parts or equivalent. Replacement parts such as intake shields, pulley shields, PTO driveline shields, winches and lift cables **MUST MEET ASAE STANDARDS** or serious injury may result. Use of unauthorized parts will void warranty. If in doubt, contact WESTFIELD or your WESTFIELD dealer. Do not modify any auger components.

DANGER



WATCH FOR OVERHEAD ELECTRICAL WIRES. ELECTROCUTION CAN OCCUR WITHOUT DIRECT CONTACT. FAILURE TO HEED THIS WARNING WILL RESULT IN SERIOUS INJURY OR DEATH.

CAUTION



SUPPORT DISCHARGE END OF AUGER BEFORE REMOVING OR REPLACING ANY PARTS ON THE UNDERCARRIAGE.

7. Index

Assembly	8	Lockout - Operational	29
Discharge Spout	24	Maintenance & Storage	33
Driveshaft	12	Maintenance Procedures	33
Driveshaft Sequence - Table III	12	Safety	6
Drive Shielding	14	Storage Procedures	34
Drive Shielding Sequence - Table IV	15	Operation	29
Flighting	8	Auger Drive & Lockout	29
Gearbox	13	Checklist	29
Intake Hitch	11	Completion/Clean-up	31
Lift Cable	22	Full Load Procedures	30
PTO Driveline	14	Normal/Emergency Shutdown	30
Safety Spout	24	Safety	3
Track Shoe	10	Start-up and Break-in	30
Track Stop, Lower	10	Placement, Transport &	26
Track Stop, Lower - Table II	10	Safety	5
Track Stop, Upper	10	PTO Driveline Installation	14
Track Stop, Upper - Table I	10	Safety First	3
Trussing	16	Decals	6, 7
Tube	8	Maintenance	6
Undercarriage	19	Operational	3
Wheels/Tires	19	Transport & Placement	3
Winch	22	Transport Hazard Zone	5
Winch Handle	23	Work Area Hazard Zone	4
Auger Drive & Lockout	29	Safety Chain Installation	27
Break-in, Start-up	30	Safety Spout Installation	24
Cable, Lift- Installation	22	Sign-off Form	Inside Front
Checklist- Operational	26	Sprockets, Upper Drive	25
Completion/Clean-up	31	Start-up & Break-in - Operational	30
Contents, Table of	iii	Storage, Maintenance &	33
Decals - Safety	6, 7	Table of Contents	iii
Discharge Spout Installation	24	Tires - Installation	19
Driveshaft Assembly	12	Track Shoe Installation	10
Driveshaft Sequence - Table III	12	Track Stop, Lower - Table II	10
Drive Shielding	14	Track Stop, Upper - Table I	10
Drive Shielding Sequence - Table IV	15	Transport & Placement	26
Drive Sprockets, Upper	25	Hazard Zone	5
Emergency Shutdown - Operational	30	Safety	3
Flighting Assembly	8	Safety Chain	27
Full Load Procedure - Operational	30	Trussing Installation	16
Gearbox Installation	13	Tube Assembly	8
Intake Hitch Assembly	11	Undercarriage Assembly	19
Introduction	1	Warranty	Inside Rear
Lift Cable Installation	22	Winch Installation	22
		Winch Handle Assembly	23
		Work Area Hazard Zone	4



WARRANTY

Westfield Industries Ltd. warrants products of its manufacture against defects in materials or workmanship under normal and reasonable use for a period of one year after date of delivery to the original purchaser.

Our obligation under this warranty is limited to repairing, replacing, or refunding defective part or parts which shall be returned to a distributor or a dealer of our Company, or to our factory, with transportation charges prepaid. This warranty does not obligate Westfield Industries Ltd. to bear the cost of labor in replacing defective parts. Any defects must be reported to the Company before the end of the one year period.

This warranty shall not apply to equipment which has been altered, improperly assembled, improperly maintained, or improperly repaired so as to adversely affect its performance. Westfield Industries Ltd. makes no express warranty of any character with respect to parts not of its manufacture.

The foregoing is in lieu of all other warranties, expressed or implied, including any warranties that extend beyond the description of the product, and the IMPLIED WARRANTY of MERCHANTABILITY is expressly excluded.

WESTFIELD INDUSTRIES LTD.
ROSENORT, MANITOBA
CANADA
ROG 1WO

WESTFIELD[®]

INDUSTRIES LTD.

a division of Ag Growth Industries
ROSENORT, MANITOBA, CANADA
R0G 1W0

(204) 746-2396

visit us at: www.grainaugers.com
e-mail us at: admin@westfieldindustries.com